

SMARTair™ Product Catalogue



Lockwood: *no worries*®



ASSA ABLOY

www.assaabloy.co.nz

Experience a safer
and more open world

SMARTair™ Commercial Access Control

SMARTair™ friendly access control solution upgrades your security to new levels – with minimal effort on your part.

SMARTair™ is an outstanding, modern high security solution, combining exceptional quality with appealing convenience and stylish design. It is ideal for a wide range of organizations and businesses in a wide range of sectors: retirement homes, small hotels, campuses, healthcare facilities, office buildings, sports clubs, government and municipal agencies, airports and many others.

Versatile SMARTair™ is available in several versions

SMARTair™ Standalone – This basic version of SMARTair™ manages access to a single door. Requiring no software or programming device, it relies on a programming card to authorize or cancel electronic access cards and/or PINs.

SMARTair™ Update-on-Card (UoC) – SMARTair™ Update-on-Card systems are built, operated and managed by the versatile SMARTair™ TS1000 software. System management is facilitated by using the users' cards to pass information from the central station to doors throughout the premises.

SMARTair™ Wireless – Controlled directly from the system manager's PC, this sophisticated version of SMARTair™ notifies managers immediately about events at every door, enabling them to change authorizations and schedules and even open distant doors – without leaving their desks.



SMARTair™ Electronic Escutcheon

(Standalone, UoC or Wireless)









The SMARTair™ wire-free and battery powered escutcheons are ideal for transit, office or meeting room doors. The wide range of escutcheons offer a RFID reader and locking mechanism in one for all kind of doors.



Wireless

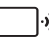

Standalone, UoC

	Door profiles	Suitable for timber or aluminium doors
	Traffic volume	Medium to high
	Exterior usage	IP55 Up to 85% humidity -20°C to +70°C
	Hardware compatibility and installation	High retrofit (compatible with most common mortise locks) Drilling, no cabling Doors from 30mm up to 110mm (thicker doors may be possible on request)
	Power supply	Battery (from 60,000 to 80,000 cycles)* max. 2 years standby** Type of batteries: 3 LR03 AAA 1.5V alkaline batteries
	Multi-authentication	There are 2 models: - RFID only - RFID and PIN (keypad)
	Certifications	Approved for use on fire doors in New Zealand***
	RFID technologies	MIFARE Classic and Ultralight HID iCLASS® **** SKIDATA**** DESFire****
	System management upgradability	Escutcheons can be upgradeable from Stand-alone > UoC Wireless Online by: • Adding RF module • Firmware upgrade • Change of internal cover (plastic top)

* Depending on reading technology (MIFARE, iCLASS etc.)

** Depending on cycles per day.

***Please consult with Door Hardware Manufacturer before ordering

****Available on request

Electronic Technical Characteristics - Wireless

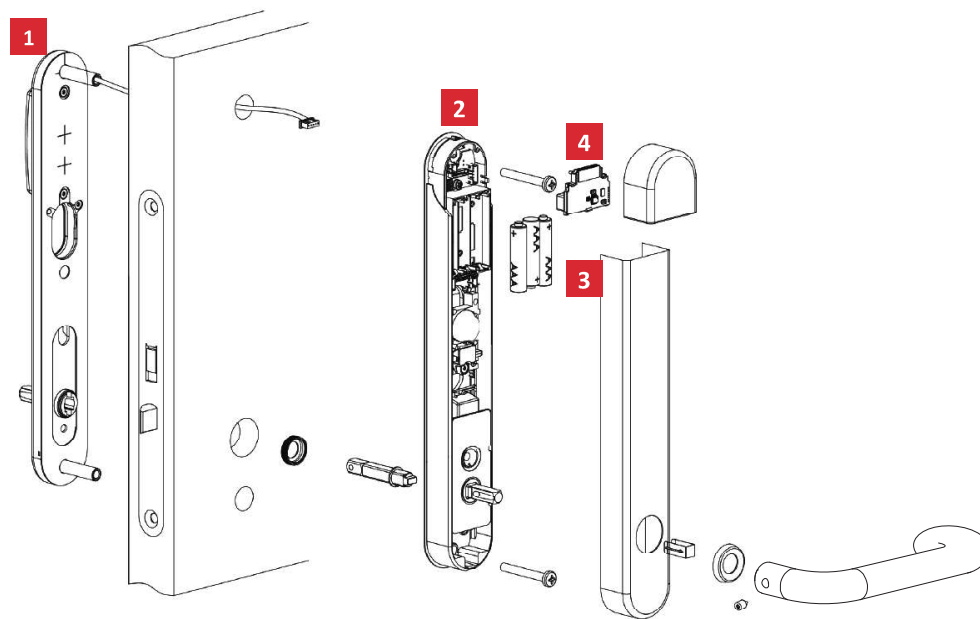

Reader Module 1

- Reading distance: 2-4cm read/write distance with standard RFID credentials.
- Emergency opening: jack connection is available to connect the portable programmer and emergency kit
- RFID reader with capacitive keypad (Keypad reader option) and backlighting LEDs (green/red/blue) for different warning signals: access authorized or denied, low battery level, etc
- Buzzer included for PIN confirmation and access denied.
- Operating modes:
 - Only RFID
 - Only PIN
 - RFID+PIN
 - PIN+RFID

Control Unit 2

- Upgradeable firmware
- Non-volatile memory. The escutcheon can be programmed to operate in 2 modes:
 - Normal mode: 1500 users and 600 events
 - High traffic door: unlimited number of users filtered into 48 groups (permissions). Stores 1000 events
- Number of PINs:
 - PIN+RFID (or RFID+PIN): unlimited PINs (stored in card)
 - Only PIN mode: 8
 - 1 door PIN
 - 7 common PINs per installation selectable in each door.

- Type of PIN: 4-6 digitals
- Read-time clock and calendar:
 - 28 time zones with 5 time periods (week days and holidays selectable)
 - State tables: configure 20 changes of operating modes in a door per day (switch door from lock to unlock)
 - Yearly calendar: is updated every month automatically by the wireless system
 - Automatic DST: daylight Saving Time change updated with calendar
- Operating modes:
 - Standard default operating mode. Freewheeling handle until valid credential presented then allows to open the door for 4-10 seconds (configurable)
 - Passage mode: escutcheon is always in open mode (configured by time zones or by authorized user after double badging)
 - Double user: two valid credentials needed to open the door
 - First user: lock in standard mode until first valid user enters, then will remain in passage mode (until closed by authorized user or automatically by time zone, state table)

Battery Module 3

- Easy battery change
- Maintains clock/calendar for 5mins without batteries.
- Battery status reported on every event or once a day if no event happens

RF Module 4

- 915MHz
- 30 configurable channels:
 - From 915.00 to 922.25MHz in steps of 0.25MHz each channel
- Auto-link with communication Hubs (easy setup)
- Upgradeable firmware

Mechanical Characteristics

Mortise Lock

- Compatible with Lockwood Selector NO HUB DISC mortise locks with varying backsets-30mm, 38mm, 60mm
- 7.6mm spindles

Door width

- Suitable for doors with a thickness from 33 to 110mm
- Spindle is dismountable, for flexibility in field

External Handle

- Freewheeling handle connects to spindle when access is granted

Internal Handle

- Free exit, internal handle always opens door



Sena



Stainless Steel Finish

How to order

S M A - S N A C 4 6 X L 2 V 6 4 8 S I

SMARTair Product	Technology Type	Reader Type	Key Override	Backset
SMA-	SNAC - STANDALONE SNCC - UPDATE ON CARD (UoC) SNZC - WIRELESS	42X - IP55, READER ONLY (MIFARE) 46X - IP55, KEYPAD + READER (MIFARE)	L1S - NO KEY OVERRIDE L2V - WITH KEY OVERRIDE	008 - NO KEY OVERRIDE 648 - CYL OVERRIDE FOR 60MM BACKSET 908 - CYL OVERRIDE FOR 30MM BACKSET



ASSA ABLOY